

Alkali

Phosphate-Free

Not a Non-Medical
Deleterious Substance

Indispensable for Cleaning Grease.

New ChemiCool



Effective against a wide variety of kitchen grime, from light staining, to greasy surfaces, to stubborn grease. Improve your degreasing performance.



Precautions for Use

- Always wear **protective eyewear and rubber/nitrile gloves!**
- Do not mix with other chemicals or cleaning agents.
- When using on walls, ceilings, or in other locations above head height, be careful of spattering or dripping liquid.
- Do not use on **aluminum, tin, copper, brassware, Galvalume steel, untreated wood, and bamboo products.**
- Always read the "Instructions for Use" and "Precautions for Use" printed on the product before use.
- Do not pour into PET bottles or aluminum cans.

Range hoods

Walls

Fryers

Gas burners

Grills

Floors

2.5 kg

4 kg

20 kg (Bag-in-Box), 4 kg, and 2.5 kg containers can be crushed for disposal after use.

Removes Stubborn Grease!

Alkaline agents with added surfactants and solvents. Penetrates deep to break down and remove grime. Requires less scrubbing for reduced labor and shorter cleaning times.

Use Diluted for Cost Savings

Suitable for light staining to burnt-on grime on gas cooktops, hoods, fryers and other cooking equipment, floors, walls, ventilating fans, and work tables.

Saves on Labor

Also effective against stubborn grease when left to soak for just a short time. No need for hard scrubbing.

Cleaning Performance

Spray cleaning (burnt-on grease)



Use the dedicated foaming spray gun for long-lasting cleaning performance even on walls. Just leave it to work. Removes grease without scrubbing or fuss.

<Use Undiluted>

Soaking (greasy surfaces)

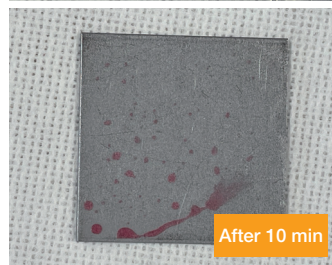
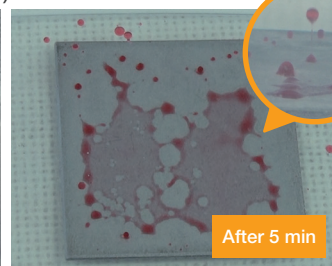
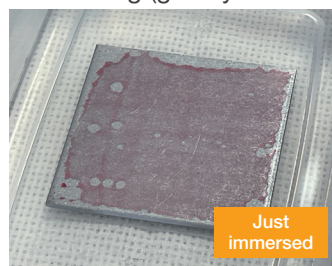

Leave to soak and the grease just floats to the surface. Perfect for cleaning objects with complex shapes, such as stove rings and wire meshes.

<Use a 200× Dilution>

Instructions for Use

⚠ Always wear dishwashing gloves!

Cleaning
a gas cooktop

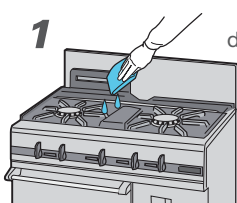

1 Apply the diluted solution and leave for 2 to 3 minute

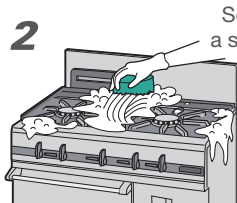

2 Scrub with a sponge or scourer



3 Wipe down with a wet dish cloth

Use a 10-fold dilution.



Cleaning the floor



1 Remove any debris from the floor



2 Spread the diluted cleaning solution



3 Scrub with a deck brush

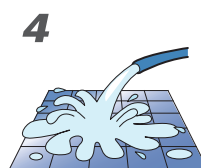

4 Rinse thoroughly with running water



5 Dry with a floor squeegee

Use a 100-fold dilution.



Accessories (sold separately)

- | | |
|--|--------|
| A Spray bottle (capacity: 500 mL) | 901120 |
| B Wide-necked spray bottle (capacity: 500 mL) | 900020 |
| C Water-Powered Foam Sprayer S (tank capacity: 1.4 L) | 901084 |
| Use with 7- to 200-fold dilution (low viscosity cleaning agents) | |



Product Data

Product Name	New ChemiCool 2.5 K (E-1)	New ChemiCool 4 K (E-1)	New ChemiCool 18 K	New ChemiCool 20 K
Packaging	2.5 kg × 6 units/case	4 kg × 4 units/case	18 kg (can)	20 kg (Bag-in-Box container)
Product Dimensions*	124 mm × 105 mm × 272 mm	203 mm × 124 mm × 254 mm	238 mm × 238 mm × 349 mm	297 mm × 297 mm × 291 mm
Case Dimensions*	446 mm × 236 mm × 282 mm	418 mm × 260 mm × 261 mm	—	—
Stacking Limit	3 cases		2 containers	3 cases
Product Code	230160	230131	230101	230102
JAN Code	4975657230345	4975657230017	4975667230161	4975657230284
ITF Code	14975657230342	14975657230014	—	—

Ingredients, etc.

◆Acidity/Alkalinity	Alkali
◆Ingredients	Alkaline agents
	• Sodium hydroxide
	• Potassium hydroxide
	Surfactants
	• Sodium alkyl ether sulfate
	Solvent
	Stabilizer
	Metal ion sequestrants

*Listed dimensions are design values for width × depth × height. The appearance and labeling of this product may be altered without notice.



Inquiries:

1-8-10 Niitaka, Yodogawa-ku, Osaka-shi 532-8560

TEL.06-6395-2717

BCAAAF